

PACKET-/OBJECT- HANDLING SYSTEMS



Secure transfers of documents and other items for a safer welcome

Packet-/object-handling systems are integrated into counters or facades and provide the means to transfer documents, tickets, envelopes and packets between a secure area and an exterior area used by the general public. Packet windows enable larger items to be passed from one side to the other and because of the way in which they are designed, they offer protection against vandalism. Some models also provide bullet-proof resistance up to BR4 level, in accordance with the EN 1063 standards.

These models of various different sizes are for transferring packets and objects to a secure area. Integrated into brickwork, these rotating packet-handling systems can be installed in facades that open up to the outdoors, provided they are sheltered from inclement weather. Packet-handling systems are designed to protect personnel against weapons attacks. BR4 ballistic protection in accordance with the EN 1063 standard. As an option, these models can be fitted with a sealing subframe or a cash-transport subframe (integrated intercom system and oculus).

ROTAPAC GÉDÉON AND ½ GÉDÉON



Reference:

- A74094: Rotapac Gédéon (RAL 7035 grey) / A74182 (with oculus)
- A74188: Rotapac ½ Gédéon (RAL 7035 grey) / A74005 (with oculus)
- A74180: Rotapac Gédéon + sealing subframe
- A74186: Rotapac Gédéon + cash-transport subframe + Intercom system / A74184 (without intercom system)
- A74178: Rotapac ½ Gédéon + sealing subframe
- A74192: Rotapac ½ Gédéon + cash-transport subframe + Intercom system / A74190 (without intercom system)



DO YOU KNOW?

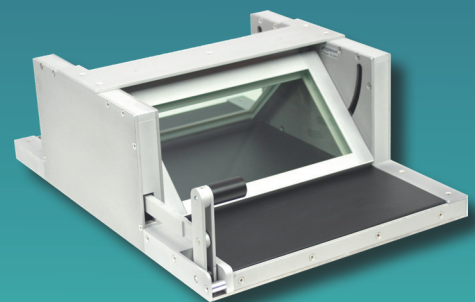

Other models in the packet-handling system range

- Sebal PM2 (vandalism proof)

ROTAPAC GÉDÉON AND ½ GÉDÉON

Specifications

Rotapac Gédéon

- Gray lacquered steel rotor and structure
- Pane that is bullet-proof along its whole height
- Use: indoors or outdoors
- Resistance: pane featuring BR4 ballistic protection in accordance with the EN 1063 standard
- Delivered assembled (fastenings not supplied)
- The intercom system is integrated into a drawer, only possible with the cash-transport subframe
- Optional:
 - Gédéon with / without oculus
 - Gédéon sealing subframe
 - Gédéon cash-transport subframe:
 - with or without intercom system
 - with oculus

Rotapac ½ Gédéon

- Gray lacquered steel rotor and structure
- Pane that is bullet-proof along one third of its height
- Use: indoors or outdoors
- Resistance: pane featuring BR4 ballistic protection in accordance with the EN 1063 standard.
- Delivered assembled (screws and fastenings not included)
- The intercom system is integrated into a drawer, only possible with the cash-transport subframe
- Optional:
 - ½ Gédéon with / without oculus
 - ½ Gédéon sealing subframe
 - ½ Gédéon cash-transport subframe:
 - with or without intercom system
 - with oculus

Operation

- Manually opened and closed with locking latch.
- Rotor rotates around a vertical axis (press the pedal opposite to release the mechanism and pivot the cylinder manually).

Installation

- Interior or exterior (except Gédéon) installation flush with the facade (in closed position), without exterior overhang.
- These packet-handling systems can be installed:
 - in concrete walls (with or without subframes)
 - in glass facades

Applications

- Service stations
- Financial institutions
- Railway stations
- Embassies
- Pharmacies

Advantages



- Can be used to pass packets and large items
- Provides employees with protection against physical attacks and is bullet-proof
- Low maintenance required

Optional

- Gédéon subframe
- ½ Gédéon subframe
- Gédéon cash-transport subframe
- ½ Gédéon cash-transport subframe

ROTAPAC GÉDÉON AND ½ GÉDÉON

Dimensions

Dimensions (mm)	Rotapac Gédéon		Rotapac 1/2 Gédéon	
				
	Overall	Useful capacity	Overall	Useful capacity
Height	928	860	498	430
Width	582	340	582	340
Depth	453	360	453	360
Weight (kg)	170		115	
Size of area to be reserved (H x L)	940 x 592 mm (excluding subframes) 950 x 590 mm (sealing subframe) outer section 1030 x 692 mm (sealing subframe) inner section 1091 x 650 mm (cash-transport subframe)		510 x 592 mm (excluding subframes) 510 x 590 mm (sealing subframe) outer section 600 x 692 mm (sealing subframe) inner section 661 x 650 mm (cash-transport subframe)	

Packaging

	Gédéon	½ Gédéon
Weight of packaging + device	185 kg	124 kg
Packaging dimensions (H x L x D)	1020 x 700 x 700 mm	590 x 700 x 700 mm
Type of packaging	Pallet + box	

ROTAPAC GÉDÉON AND ½ GÉDÉON

Technical specifications

Gédéon

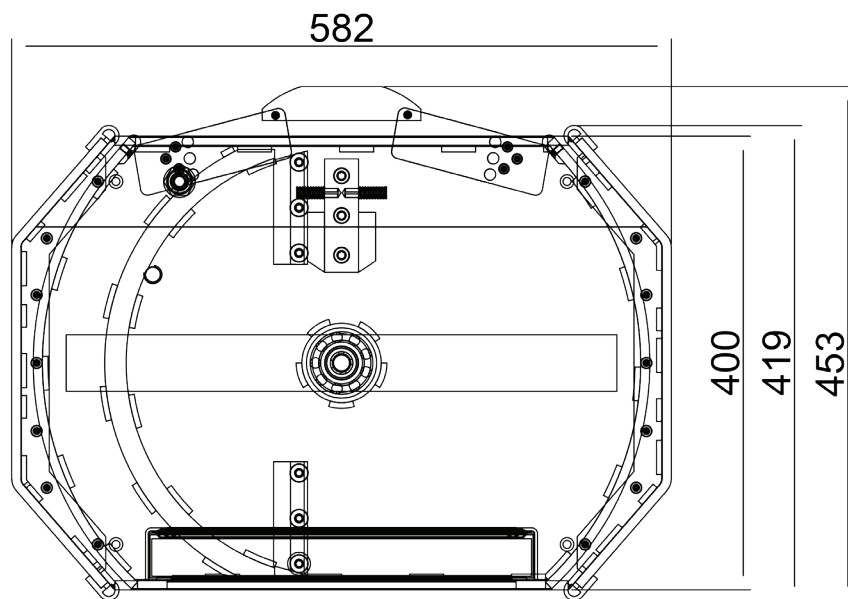
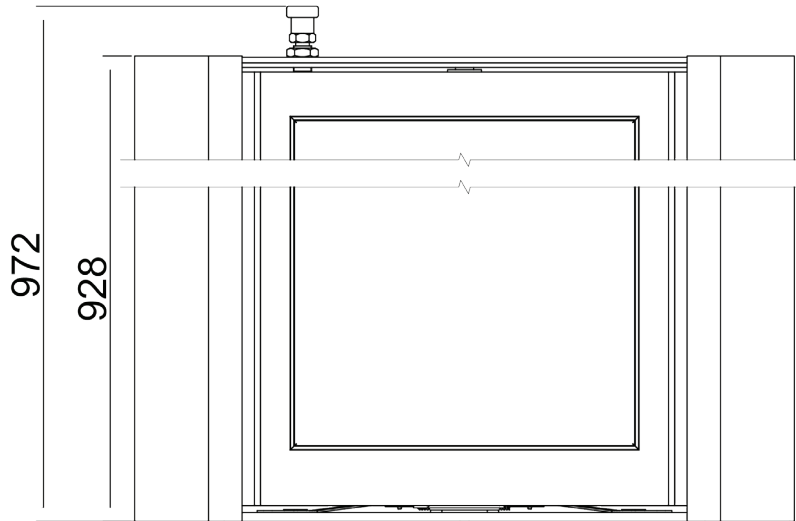

ROTAPAC GÉDÉON AND ½ GÉDÉON

Technical specifications

½ Gédéon

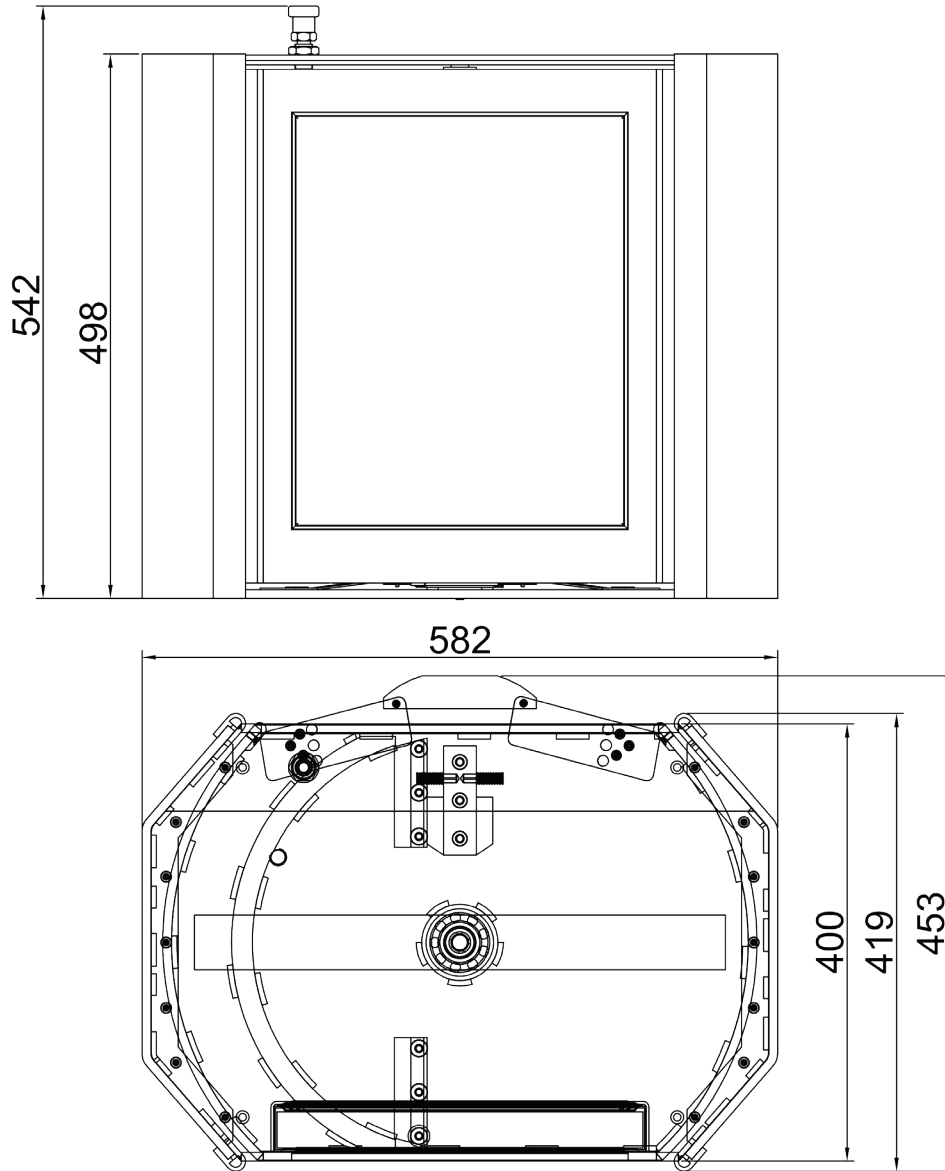

ROTAPAC GÉDÉON AND ½ GÉDÉON

Technical specifications

Gédéon sealing subframe

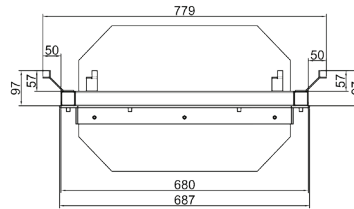
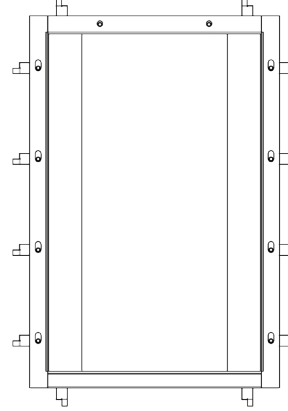
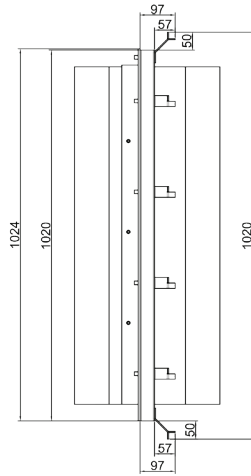

Gédéon cash-transport subframe

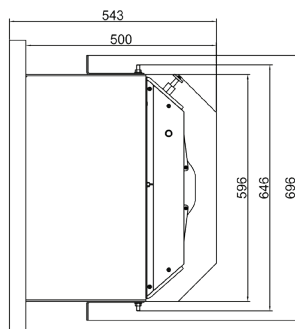
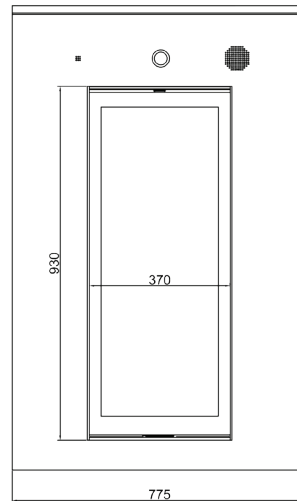
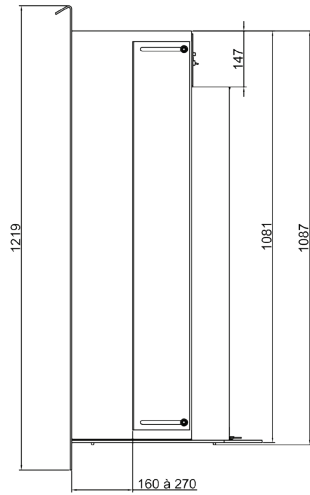

ROTAPAC GÉDÉON AND ½ GÉDÉON

Technical specifications

½ Gédéon sealing subframe

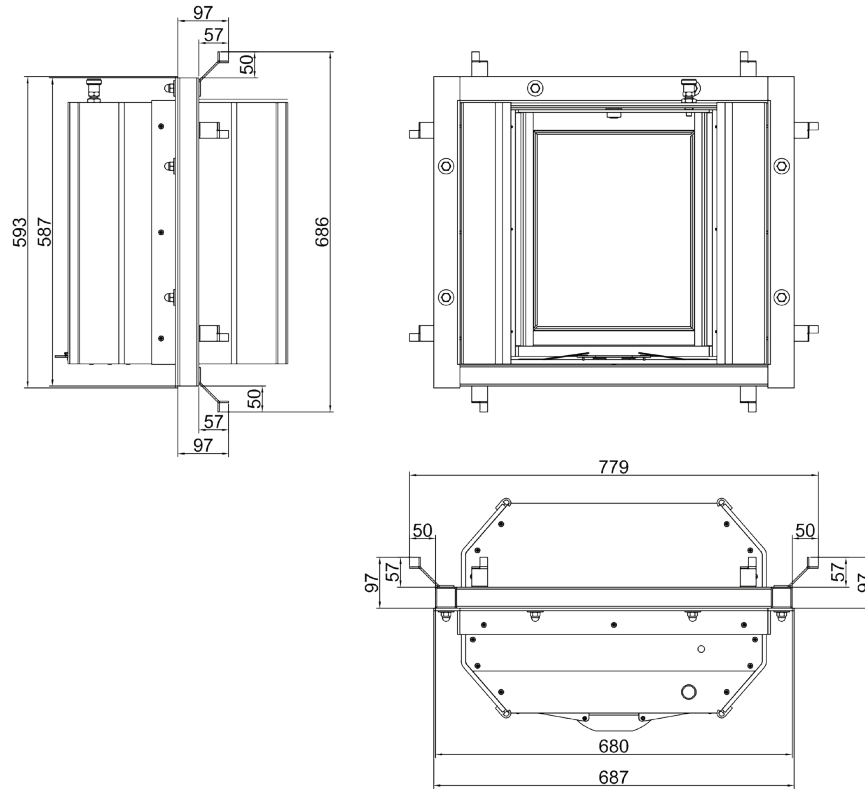

½ Gédéon cash-transport subframe

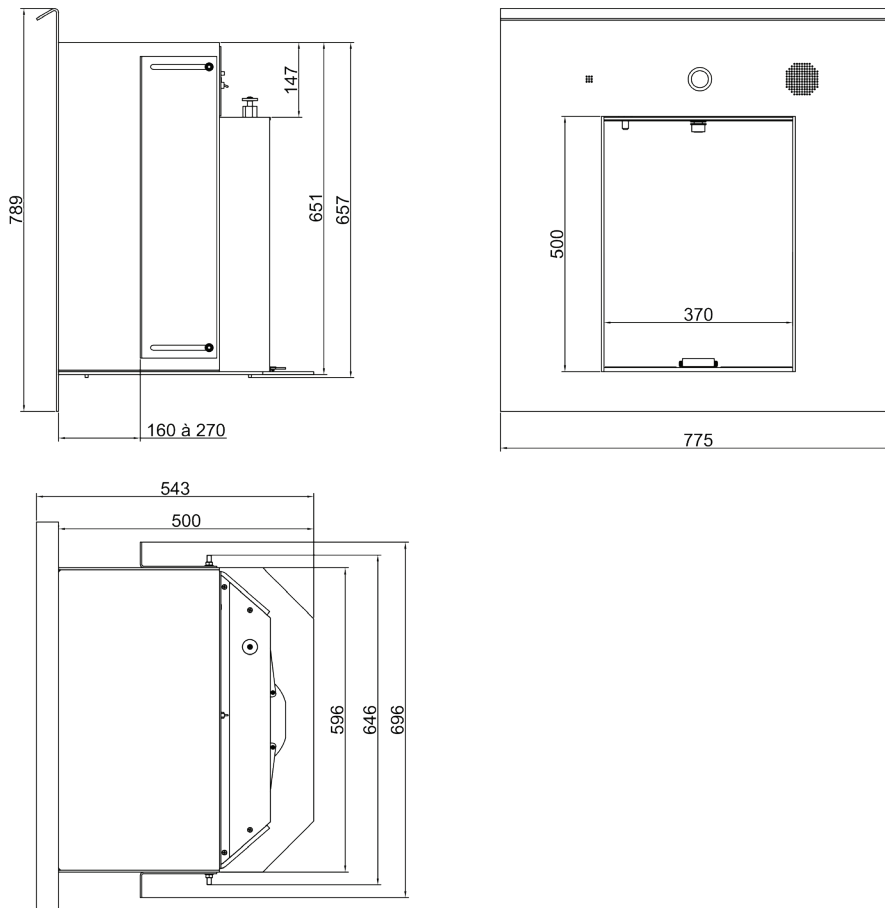



www.hygiaphone.fr

